



03-011B
2 May, 2007

CONVERSION OF M200A REACTION CELL TO "E" STYLE CELL

I. PURPOSE:

This service note lists parts and instructions for converting the M200A reaction cell to fit the new M200E style orifice holders. These orifice holders are a single piece into which the O-Rings, orifice, sintered filter and spring are pre-loaded. This enables rapid field replacement of the O-Rings and sintered filter by allowing the user to change the entire holder instead of changing parts individually. The holder can then be brought back to the user's shop and the O-Rings and sintered filter renewed when convenient. The KIT comes with everything you need to upgrade the reaction cell. We also recommend you purchase the optional parts listed for backup and convenient replacement. This will give you a spare orifice holder for each of the two orifices used in the M200A reaction cell. You can then swap the orifice holders in the field, and service the old units offsite.

II. TOOLS:

#2 Phillips head screw driver
7/16" Open end wrench
9/16" Open end wrench

III. PARTS:

KIT168
T-API PN# 04550-0100 (Optional) replacement 4 mil orifice holder pre-loaded
T-API PN# 04550-0300 (Optional) replacement 10 mil orifice holder pre-loaded

IV. PROCEDURE:

1. Turn power to the analyzer off.
2. Remove cover from the analyzer.
3. Locate the reaction cell.
4. Disconnect two 1/8" and one 1/4" tubes from reaction cell.
5. Disconnect the heater connector from the reaction cell.
6. Remove the 4 screws in the reaction cell and pull the reaction cell assy out of the chassis.
7. The reaction cell assembly consists of two sub-assemblies. One assembly consists of the stainless steel manifold, the orifices and the nozzles, as well as the heaters and thermistor. Remove the heaters and thermistor assembly from this part of the reaction cell, (see Figure 1).
8. Install the heaters and thermistor assembly onto the new manifold block assy in the kit. The new manifold assembly comes complete with nozzles and pre-loaded orifice holders already installed. Discard the old manifold assembly.
9. Assembly is the reverse of removal.

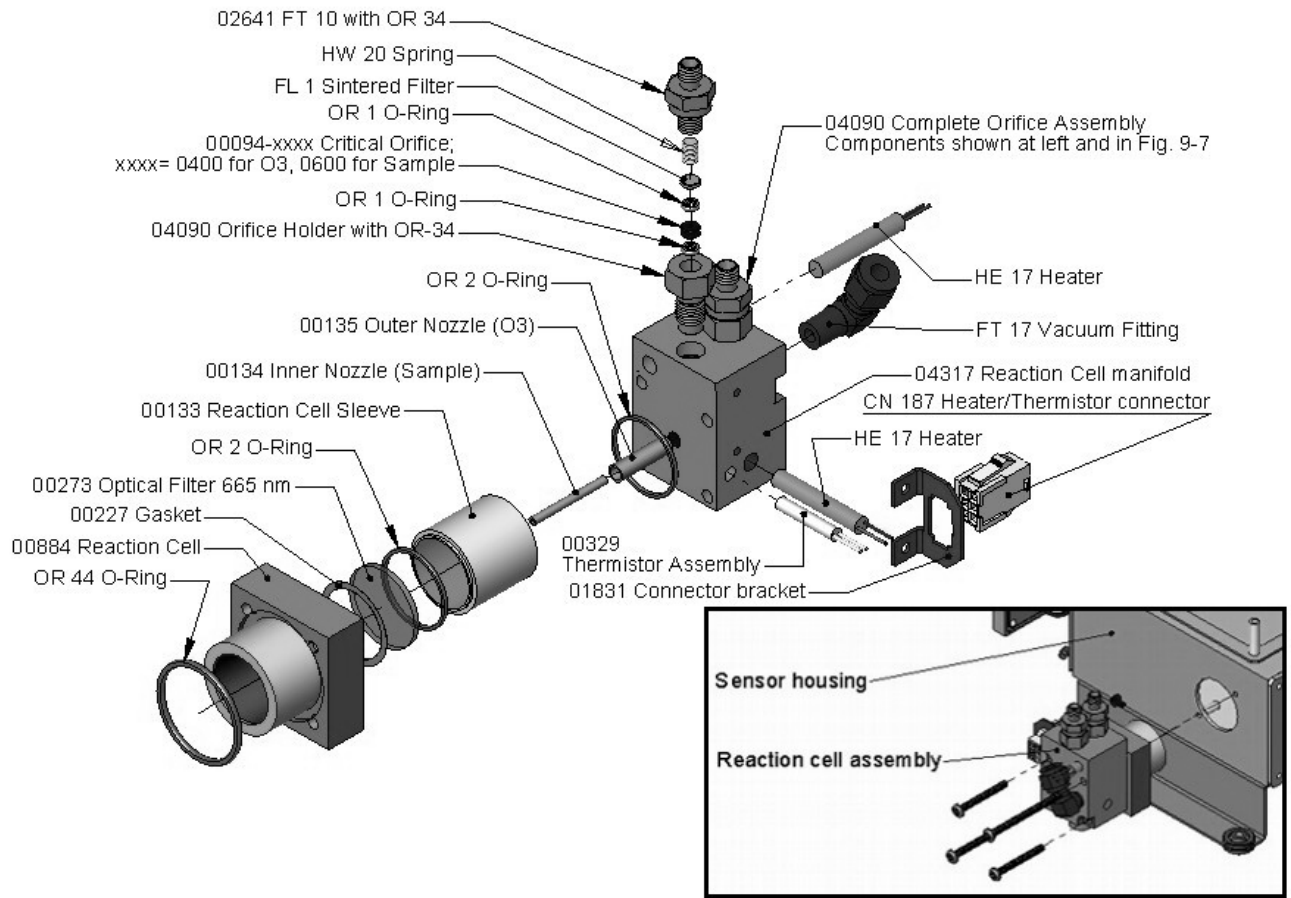

Conversion of M200A Rcell to "E" Style Orifice Holders

03-011 Rev B

Page 2 of 2