



94-001  
2 May, 2007

220 V /50 Hz 501 RETRO FIT INSTRUCTIONS

The 501 Hi Temp Convertor has been redesigned to eliminate the possibility of a malfunction of the temperature controller. To avoid any potential relay failures in the controller the following modification is required. If unable to install the retrofit, please call the factory at 1-800-324-5190 for help or return authorization number. The retrofit kit included is part 0 0127101.

To install:

Tools needed: blade screwdrivers #1, #2  
cross point screwdriver #2.

Turn power off to 501.

Remove cover to 501.

Install relay-find hole on print 1030 sheet 2 "have now". Place relay here and attach with screw/nut combination, and now tighten nut.

Remove wire from TB1-2B at controller pin 5.

Put wire from TB1-2B to relay pin 3.

Remove wire from transformer pin 3 at controller pin 4.

Put wire from transformer pin 3 to relay pin 1.

Add jumper wire from controller pin 4 to pin 7.

Add wire from TB1-2B to relay pin 2.

Add wire from TB1-7A to relay pin 4.

Kit includes:

| Part  | Qty   | Location                         |
|-------|-------|----------------------------------|
| RL-9  | 1.0   |                                  |
| WR-28 | 4.0"  | Controller pin 4 to pin 7        |
| WR-44 | 10.0" | TB1-7A to relay pin 4            |
| WR-27 | 10.0" | TB1-2B to relay pin 2            |
| WR-27 | 8.0"  | Transformer pin 3 to relay pin 1 |
| SN9   | 1.0   | Hold relay nut                   |
| SN87  | 1.0   | Hold relay screw #8              |

Have now

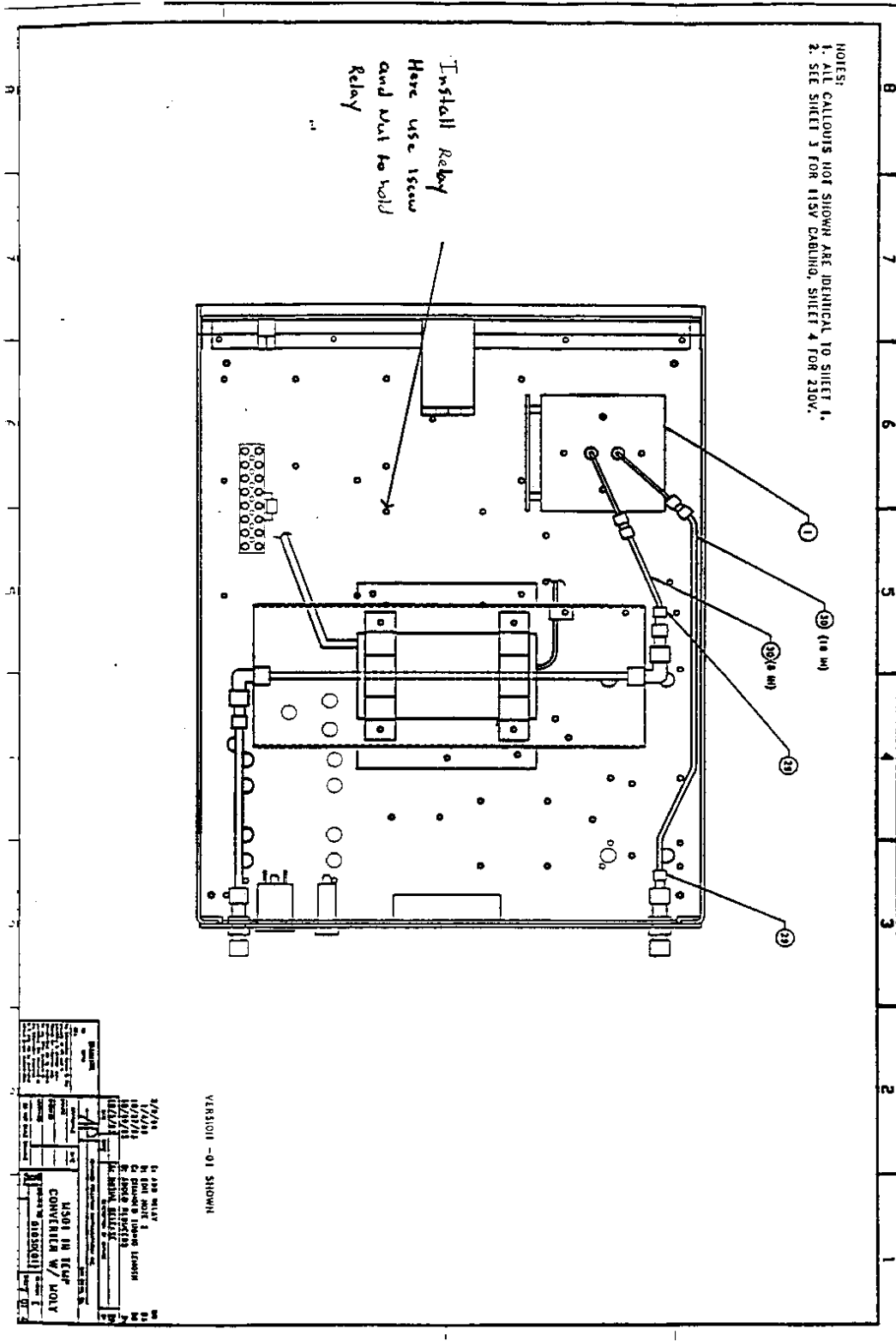

When Finished

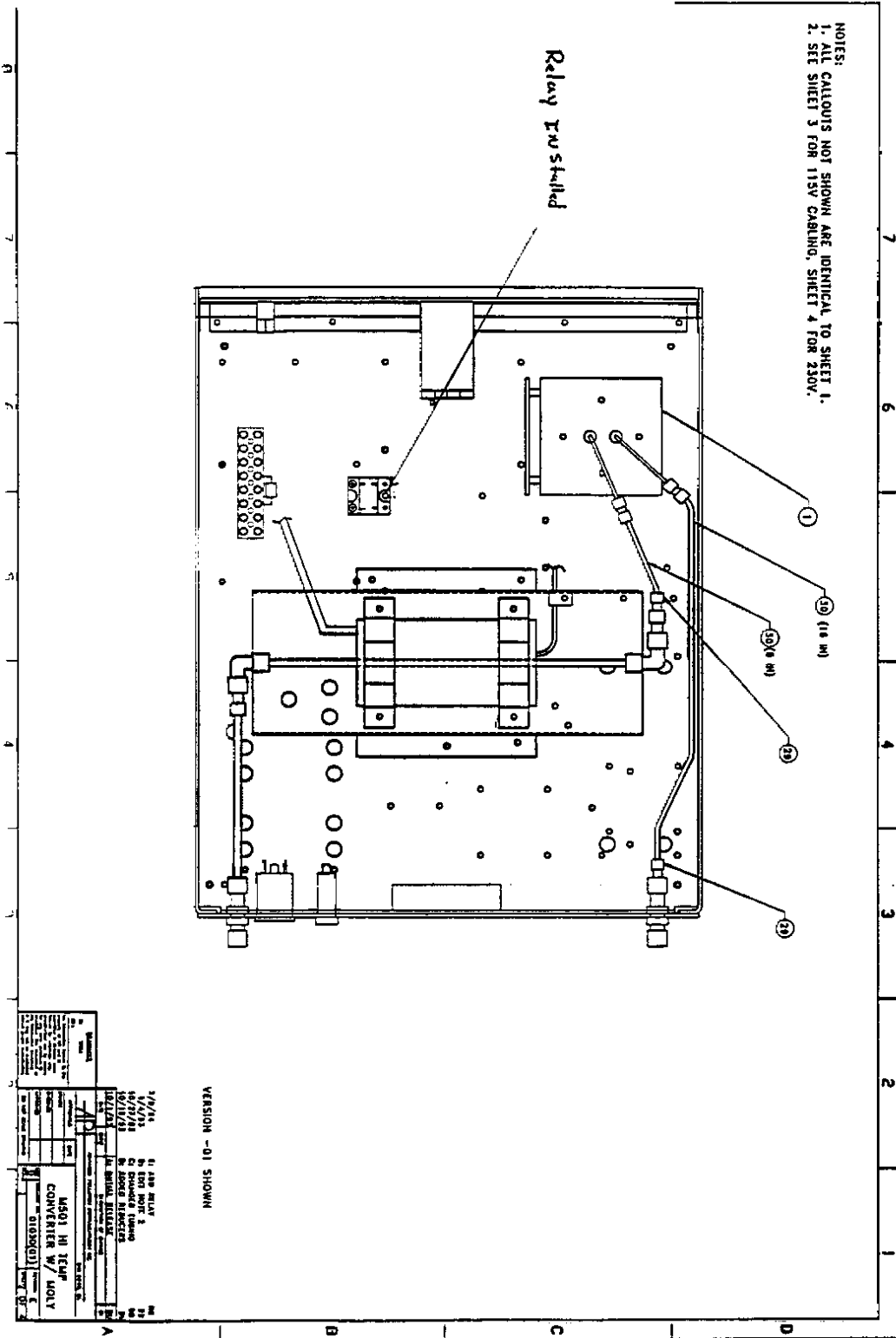

Ha Now

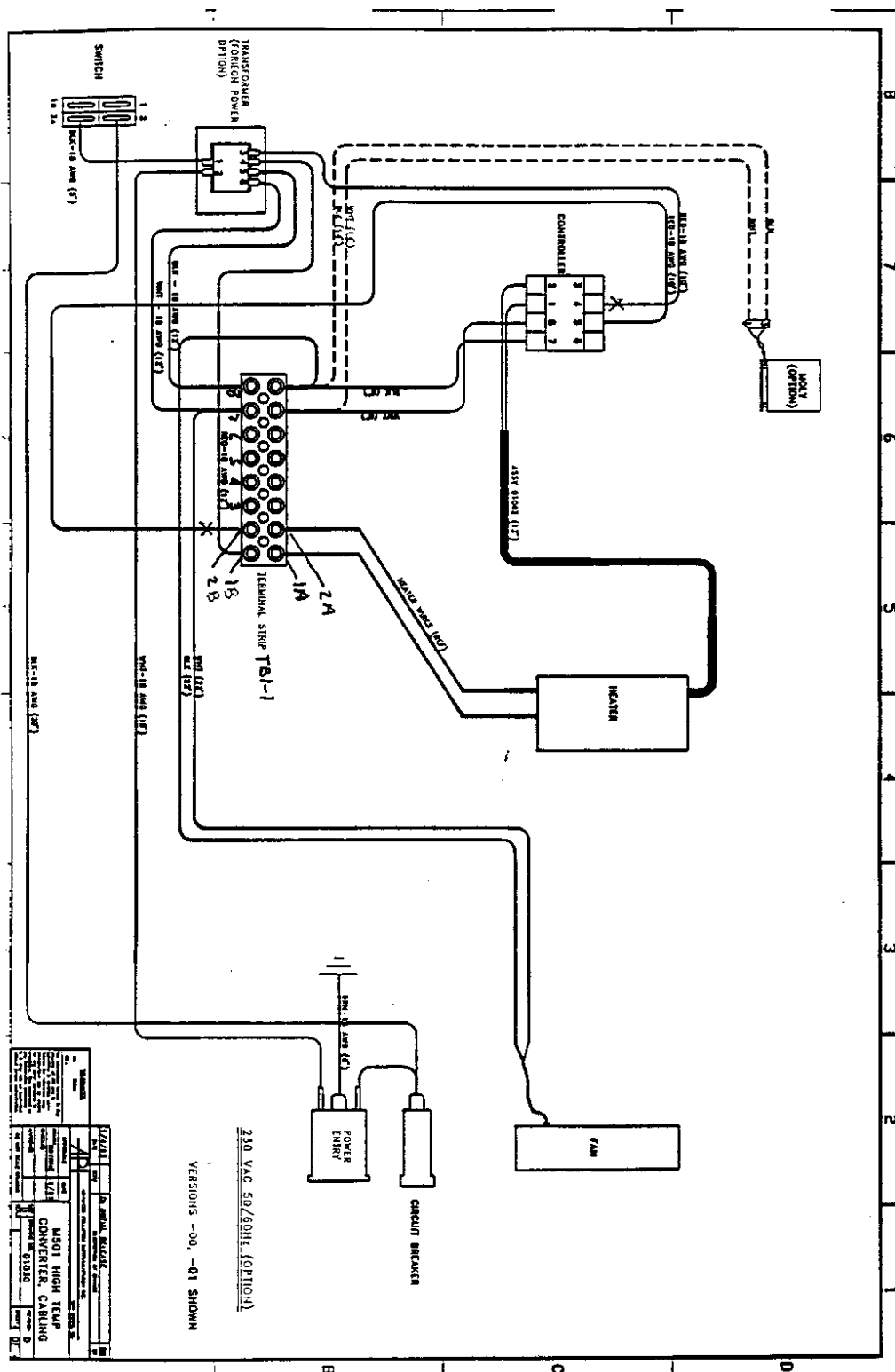

|  |                                       |                                       |                                       |
|--|---------------------------------------|---------------------------------------|---------------------------------------|
| <b>230 VAC 50/60Hz (OPTION)</b><br>VERSIONS -00, -01 SHOWN |                                       |                                       |                                       |
| TITLE<br>MASOI HIGH TEMP<br>CONVERTER, CABLING             | DRAWING NO.<br>01030                  | DESIGNED BY<br>D                      | CHECKED BY<br>D                       |
| PARTS LIST<br>1<br>2<br>3                                  | 18E-18 AMP (127V)<br>18-18 AMP (127V) | 18E-18 AMP (127V)<br>18-18 AMP (127V) | 18E-18 AMP (127V)<br>18-18 AMP (127V) |

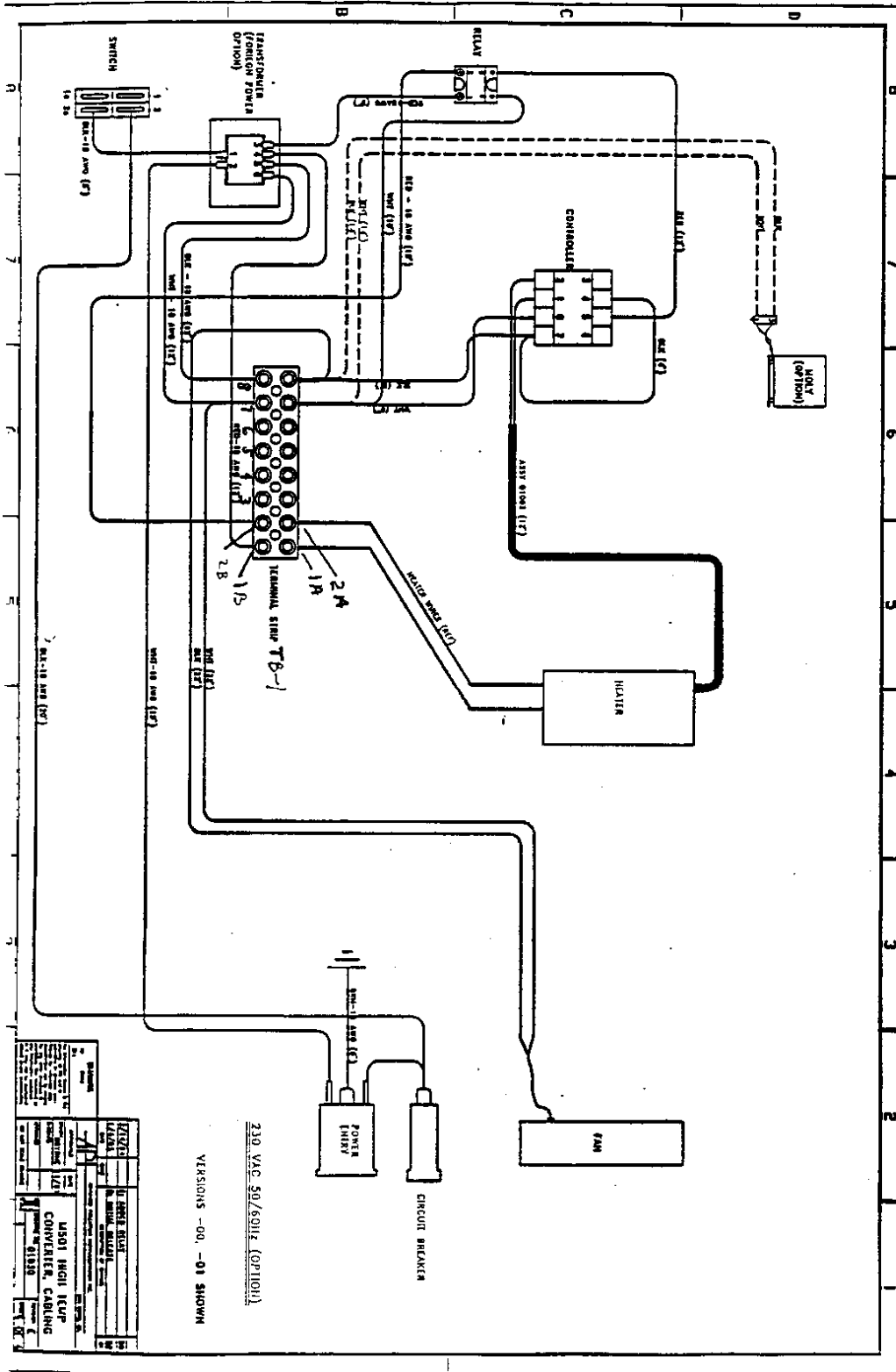

Wh.m Done